

Sponsor Booth Graphics

Booth #

Reserve

Booth Header



The header background is white. Standard header is black copy on a white background.

Panel Upgrade

WANT TO UPGRADE MY BOOTH GRAPHICS

Option 1: Insert Panel

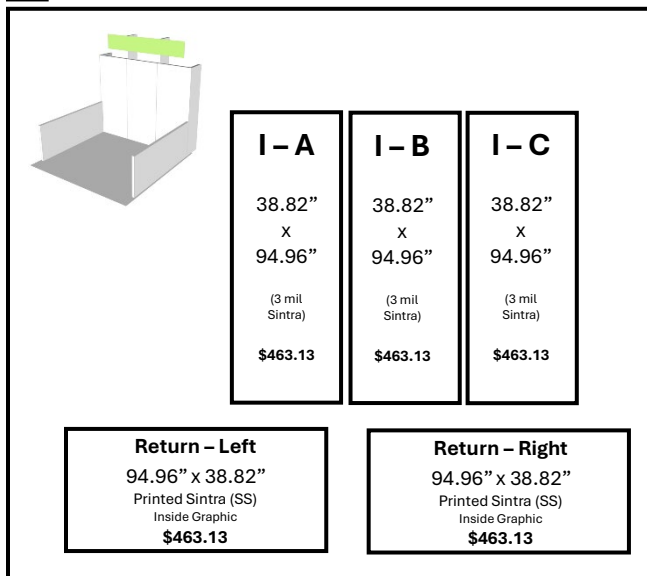

I - A	I - B	I - C
38.82"	38.82"	38.82"
X	X	X
94.96"	94.96"	94.96"
(3 mil Sintra)	(3 mil Sintra)	(3 mil Sintra)
\$463.13	\$463.13	\$463.13

Return - Left 94.96" x 38.82" Printed Sintra (SS) Inside Graphic \$463.13	Return - Right 94.96" x 38.82" Printed Sintra (SS) Inside Graphic \$463.13
---	--

Option 2: Seamless Panel (returns are insert panels)

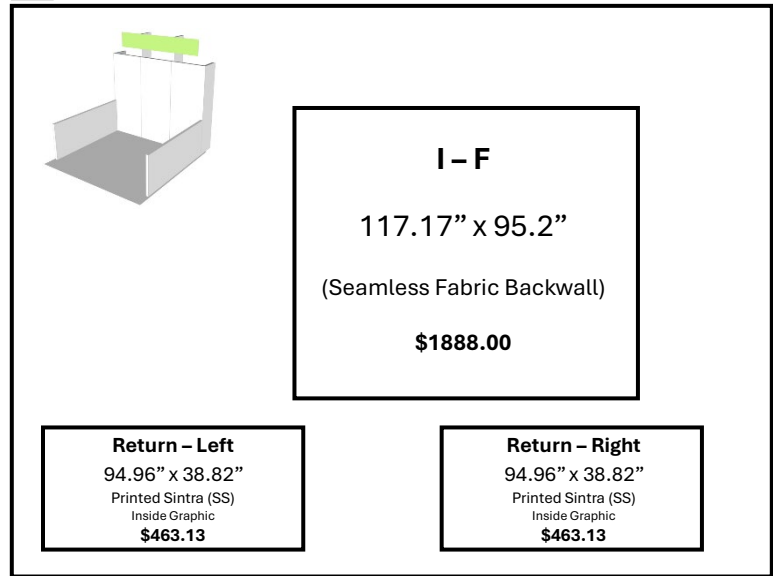

I - F 117.17" x 95.2" (Seamless Fabric Backwall) \$1888.00	
---	--

Return - Left 94.96" x 38.82" Printed Sintra (SS) Inside Graphic \$463.13	Return - Right 94.96" x 38.82" Printed Sintra (SS) Inside Graphic \$463.13
---	--

All files should be submitted in EPS or AI format in CMYK file, 150 – 200 DPI – upload files: [Click Here](#)

Artwork Submission Deadline.....9/16/2026

Artwork Approval Deadline..... 9/30/2026

Sponsor Booth Accessories

Reserve

All items are sold separately from the booth packages.

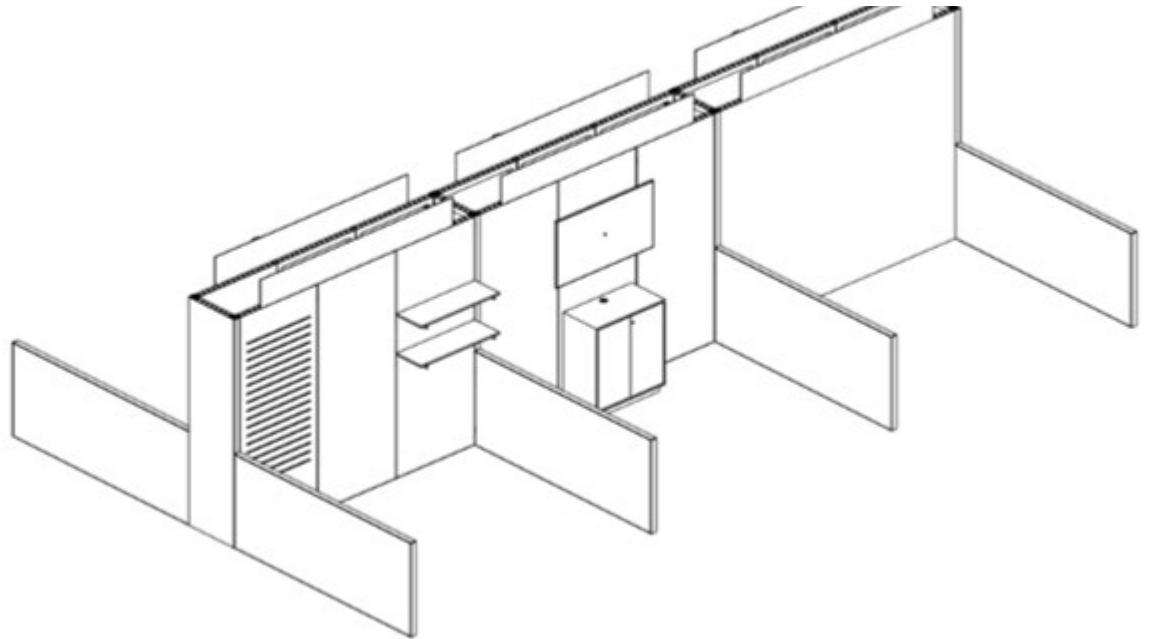
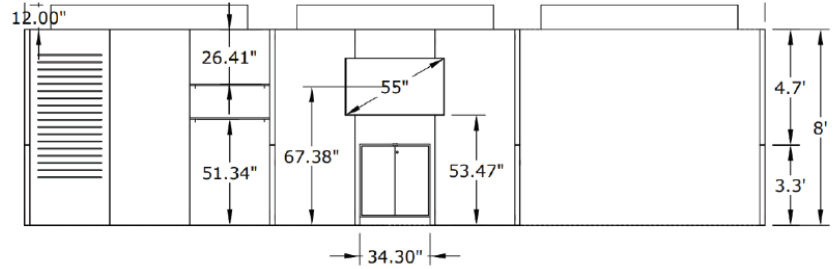

W - A
37 3/4" w Slat Wall



W - B
37 3/4" w Wire Wall

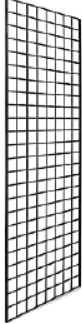

SW - A
12" Metal Slatwall
Faceout Hooks - Chrome



SW - B
8" Metal Slatwall
Faceout Hooks - Chrome



SW - C
10" Metal Slatwall Peg
Hook Angled Tip - Chr



SW - D
8" Metal Slatwall Peg
Hook Angled Tip -
Chrome



SW - E
Brochure Packet Holder
Slatwall 8 1/2" x 11" -
Clear



SW - F
Brochure Packet Holder
Slatwall 4" x 9" - Clear



SW - G
8" x 24" Slatwall Shelf w/
Brackets - White



SW - H
12" x 24" Slatwall Shelf
w/ Brackets - White





ART SUBMISSION GUIDELINES

Accepted Print-Ready File Formats

Please submit artwork in one of the following formats:

- ✓ .ai
- ✓ .eps
- ✓ .pdf
- ✓ .jpg

Unsupported File Types

We do **not** accept artwork submitted in:

- ✗ Word, Excel or Works
 - ✗ Quark
 - ✗ CorelDRAW
-

Export files from **Adobe Illustrator, Photoshop, or InDesign** with:

- All fonts converted to outlines
- All high-resolution images embedded

Important Notes

- Ziflow does **not** accept zipped files.
 - If your files are too large to upload, please use a file-transfer service such as WeTransfer.
-

ARTWORK REQUIREMENTS

Color Mode

- All artwork must be created in **CMYK color mode**.

Color Matching

- We can attempt to match **PMS colors** - please include PMS specifications in your submission instructions.
- Digital printing cannot always reproduce PMS spot colors exactly; we will color-correct artwork to achieve the closest possible match.
- If PMS matching is required, files **must be submitted as an Illustrator PDF**.
(*Flattened Photoshop files cannot be adjusted for PMS color matching.*)

Artwork Size & Resolution

- Resolution: **150–200 dpi at 100% final scale**
- Include **1 inch bleed** on all sides beyond the artboard
- **Do not include crop marks**

Images

- All raster images must be **embedded** in the artwork.
- If an image does not appear sharp at 100% size on your screen, it will not print clearly.

File Naming Convention

Please include: Sponsor level_Company name_Panel identification

Example: Gold_CompanyName_PanelA_xxx

Final Submission Checklist

Before submitting, please confirm:

- ✓ Files are print-ready
- ✓ CMYK color mode
- ✓ Minimum 150 dpi resolution
- ✓ Artwork at 100% scale
- ✓ Fonts converted to outlines
- ✓ All images embedded
- ✓ 1" bleeds included
- ✓ No crop marks

ORDER FORM – CUSTOM GRAPHICS

Contact Name: _____

Company Name: _____

Email: _____ Phone: _____

Booth Number: _____ Activation Area: _____

Discount Deadline: **Monday, October 5, 2026**

Please Note: A Credit Card must be on file to ensure payment for your order. No goods or services will be rendered without a credit card accompanying this order. Your preferred method of payment will be used, if other than the credit card on file, to complete this order at the close of the show. Please visit the Willwork Service Desk to finalize your invoice. No adjustments will be made after the close of the show.

ITEM	QTY	PANEL	TOTAL
Insert Panel Option 1: I-A - \$463.13			
Insert Panel Option 1: I-B - \$463.13			
Insert Panel Option 1: 1-C - \$463.13			
Insert Panel Option 1: Return - Left - \$463.13			
Insert Panel Option 1: Return - Right - \$463.13			
Seamless Panel Option 2: I-F - \$1888.00*			
(*Fabric Seamless Backwall)			
Seamless Panel Option 2: Return - Left - \$463.13			
Seamless Panel Option 2: Return - Right - \$463.13			

Total \$ _____ Sales Tax (8.38%) _____

ORDER FORM – SLATWALL & SLATWALL ACCESSORIES

Contact Name: _____

Company Name: _____

Email: _____ Phone: _____

Booth Number: _____ Activation Area: _____

Discount Deadline: **Monday, October 5, 2026**

Please Note: A Credit Card must be on file to ensure payment for your order. No goods or services will be rendered without a credit card accompanying this order. Your preferred method of payment will be used, if other than the credit card on file, to complete this order at the close of the show. Please visit the Willwork Service Desk to finalize your invoice. No adjustments will be made after the close of the show.

ITEM	QTY	PANEL	TOTAL
W-A 37 3/4" W Slat Wall: Panel A - \$385.00			
W-A 37 3/4" W Slat Wall: Panel B - \$385.00			
W-A 37 3/4" W Slat Wall: Panel C - \$385.00			
W-B 37 3/4" W Wire Wall: Panel A - \$358.00			
W-B 37 3/4" W Wire Wall: Panel B - \$358.00			
W-B 37 3/4" W Wire Wall: Panel C - \$358.00			
SW-A 12" Metal Slatwall Faceout Hooks Chrome - \$18.00 ea			
SW-B 8" Metal Slatwall Faceout Hooks Chrome - \$14.00 ea			
SW-C 10" Metal Slatwall Peg Hook, Angled Tip (Chrome) - \$9.00 ea			
SW-D 8" Metal Slatwall Peg Hook, Angled Tip (Chrome) - \$7.00 ea			
SW-E Brochure Pocket Holder for Slatwall 8 1/2"x11" (Clear) - \$22.00 ea			
SW-F Brochure Pocket Holder for Slatwall 4"x9" (Clear) - \$20.00 ea			
SW-G 8" x 24" Slatwall Shelf w/Brackets (White) - \$44.00 ea			
SW-H 12" x 24" Slatwall Shelf w/Brackets (White) - \$56.00 ea			

Total \$ _____ Sales Tax (8.38%) _____