



## IMPORTANT TURNKEY BOOTH PACKAGE CUSTOMIZATION INFORMATION

### CUSTOMIZATION INFORMATION

Turnkey Booth Packages can be customized for this year's event for an extra cost.

Additional customization options include:

- Wall graphic(s) – Insert and Seamless Panels
- Slat wall panel and accessories
- Monitor

Willwork's Design Team will reach out to Turnkey Booth Package exhibitors to see if they are interested in adding additional customizations.

If interested, the design team will then work with the exhibitor to come up with a booth layout that includes the new customizations.

Once the layout has been reviewed and approved by the exhibitor, Willwork will send an Order Confirmation / Quote to the exhibitor detailing all the customization charges – to review and approve.

Once the Order Confirmation is approved payment instructions will be sent. Once payment is received, the full order will be sent to production.

For any Turnkey Customization questions, please contact: [Becky.lujan@willwork.com](mailto:Becky.lujan@willwork.com)

Please see the following pages for further details.

## Welcome to McKesson ideaShare 2026!

Please see below how your header copy will appear on your booth. Please double check the copy and approve for production.

If you would like to upgrade your booth graphics please email Becky Lujan below. Thank You!

Company Name:

Contact Name:  Phone:  email:

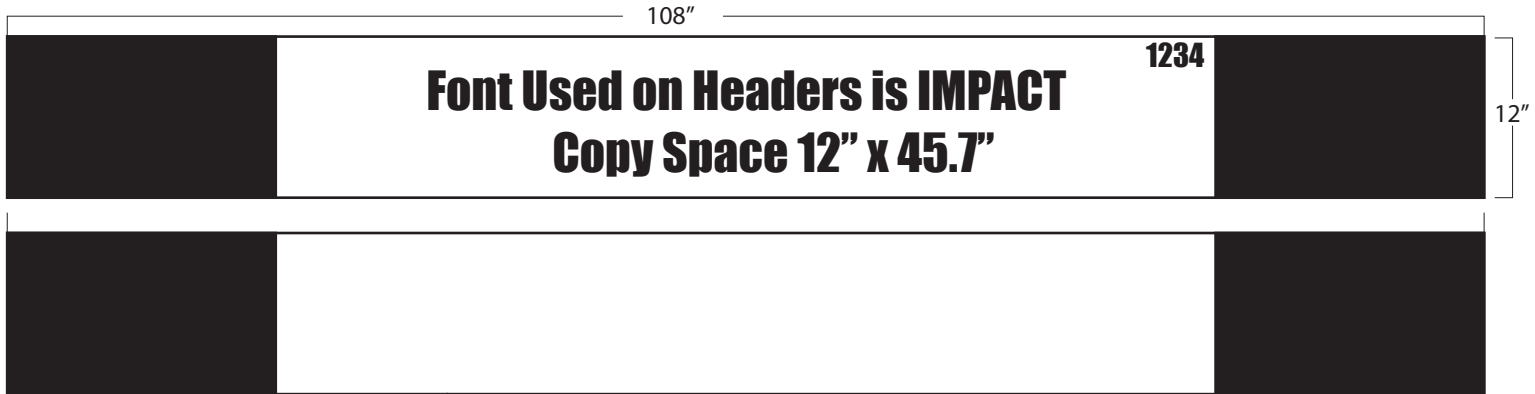

Header background is White. Standard header is Black Copy on White.  
If you choose to add your company logo it must go on a white background.

Approved By:  Date:

- REVISIONS NEEDED   
  NO HEADER NEEDED   
  WANT TO UPGRADE MY BOOTH GRAPHICS

### Insert Panel Option 1

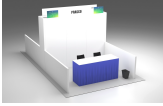
	<p><b>I-A</b></p> <p>38.82"X94.96" (3mil Sintra)</p> <p><b>\$463.13</b></p>	<p><b>I-B</b></p> <p>38.82"X94.96" (3mil Sintra)</p> <p><b>\$463.13</b></p>	<p><b>I-C</b></p> <p>38.82"X94.96" (3mil Sintra)</p> <p><b>\$463.13</b></p>
<p><b>Return - Left</b></p> <p>Printed Sintra (SS) 38.82" x 94.96" Inside Graphic</p> <p><b>\$463.13</b></p>	<p><b>Return - Right</b></p> <p>Printed Sintra (SS) 38.82" x 94.96" Inside Graphic</p> <p><b>\$463.13</b></p>		

### Seamless Panel Option 2 (Returns are insert panels)

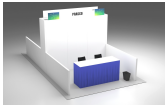
	<p><b>I-F</b></p> <p>117.17" x 95.2" (Fabric Seamless Backwall)</p> <p><b>\$1888.00</b></p>
<p><b>Return - Left</b></p> <p>Printed Sintra (SS) 38.82" x 94.96" Inside Graphic</p> <p><b>\$463.13</b></p>	<p><b>Return - Right</b></p> <p>Printed Sintra (SS) 38.82" x 94.96" Inside Graphic</p> <p><b>\$463.13</b></p>

All files should be submitted in a EPS or AI format in a CMYK file with all fonts and created to outlines.  
We will then send you a proof with your logo to scale for final approval prior to production.

Please return all approved header copy to: [Becky.lujan@willwork.com](mailto:Becky.lujan@willwork.com) no later than Friday, May 1, 2026  
If orders are not received by June 1st your header will be printed as shown on proof.

## Welcome to McKesson ideaShare 2026!

Please see below how your header copy will appear on your booth. Please double check the copy and approve for production.

If you would like to upgrade your booth graphics please email Becky Lujan below. Thank You!

Company Name:

Contact Name:  Phone:  email:

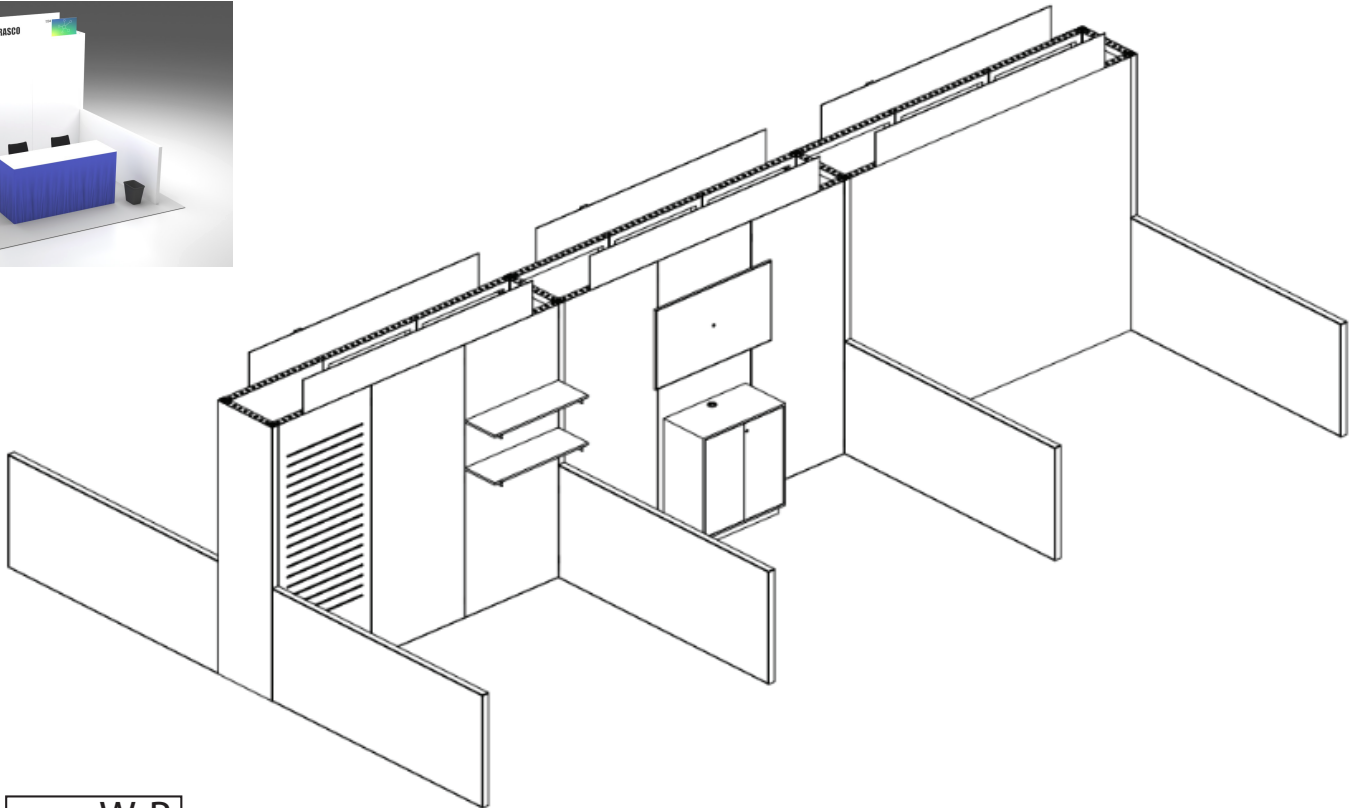
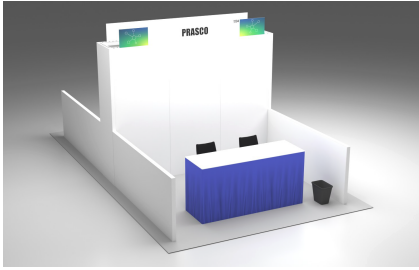

37 3/4" W Slat Wall

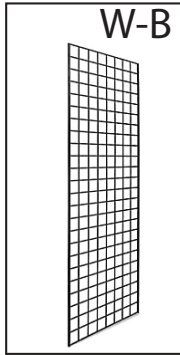

37 3/4" W Wire Wall

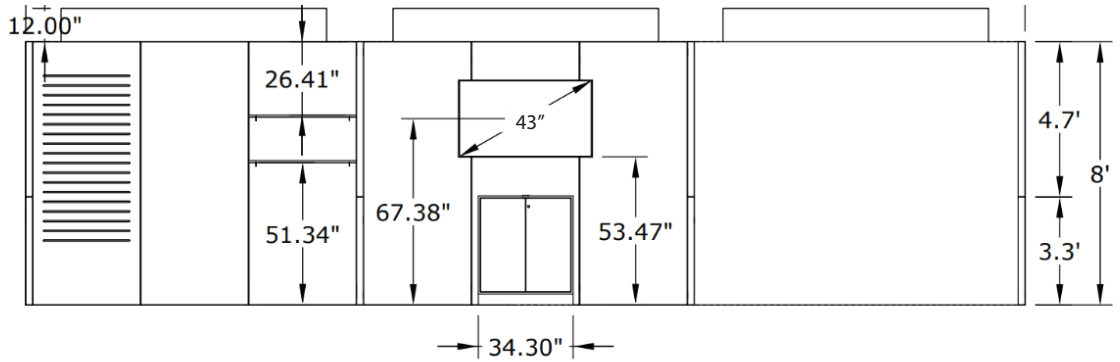

### SLATWALL ACCESSORIES



12" Metal Slatwall Faceout Hooks Chrome



8" Metal Slatwall Faceout Hooks Chrome



10" Metal Slatwall Peg Hook, Angled Tip (Chrome)



8" Metal Slatwall Peg Hook, Angled Tip (Chrome)



Brochure Pocket Holder for Slatwall 8 1/2"X11" (Clear)



Brochure Pocket Holder for Slatwall 4"X9" (Clear)



8" x 24" Slatwall Shelf w/Brackets (White)



12" x 24" Slatwall Shelf w/Brackets (White)

Please return all approved header copy to: [Becky.lujan@willwork.com](mailto:Becky.lujan@willwork.com) no later than Friday, May 1, 2026

*If orders are not received by June 1st your header will be printed as shown on proof.*

# ORDER FORM – CUSTOM GRAPHICS

Contact Name: \_\_\_\_\_

Company Name: \_\_\_\_\_

Email: \_\_\_\_\_ Phone: \_\_\_\_\_

Booth Number: \_\_\_\_\_ Activation Area: \_\_\_\_\_

Please Note: A Credit Card must be on file to ensure payment for your order. No goods or services will be rendered without a credit card accompanying this order. Your preferred method of payment will be used, if other than the credit card on file, to complete this order at the close of the show. Please visit the Willwork Service Desk to finalize your invoice. No adjustments will be made after the close of the show.

ITEM	QTY	PANEL	TOTAL
Insert Panel Option 1: I-A - \$463.13			
Insert Panel Option 1: I-B - \$463.13			
Insert Panel Option 1: 1-C - \$463.13			
Insert Panel Option 1: Return - Left - \$463.13			
Insert Panel Option 1: Return - Right - \$463.13			
Seamless Panel Option 2: I-F - \$1888.00*			
(*Fabric Seamless Backwall)			
Seamless Panel Option 2: Return - Left - \$463.13			
Seamless Panel Option 2: Return - Right - \$463.13			

Total \$ \_\_\_\_\_

# ORDER FORM – SLATWALL & SLATWALL ACCESSORIES

Contact Name: \_\_\_\_\_

Company Name: \_\_\_\_\_

Email: \_\_\_\_\_ Phone: \_\_\_\_\_

Booth Number: \_\_\_\_\_ Activation Area: \_\_\_\_\_

Please Note: A Credit Card must be on file to ensure payment for your order. No goods or services will be rendered without a credit card accompanying this order. Your preferred method of payment will be used, if other than the credit card on file, to complete this order at the close of the show. Please visit the Willwork Service Desk to finalize your invoice. No adjustments will be made after the close of the show.

ITEM	QTY	PANEL	TOTAL
W-A 37 3/4" W Slat Wall: Panel A - \$385.00			
W-A 37 3/4" W Slat Wall: Panel B - \$385.00			
W-A 37 3/4" W Slat Wall: Panel C - \$385.00			
W-B 37 3/4" W Wire Wall: Panel A - \$358.00			
W-B 37 3/4" W Wire Wall: Panel B - \$358.00			
W-B 37 3/4" W Wire Wall: Panel C - \$358.00			
SW-A 12" Metal Slatwall Faceout Hooks Chrome - \$18.00 ea			
SW-B 8" Metal Slatwall Faceout Hooks Chrome - \$14.00 ea			
SW-C 10" Metal Slatwall Peg Hook, Angled Tip (Chrome) - \$9.00 ea			
SW-D 8" Metal Slatwall Peg Hook, Angled Tip (Chrome) - \$7.00 ea			
SW-E Brochure Pocket Holder for Slatwall 8 1/2"x11" (Clear) - \$22.00 ea			
SW-F Brochure Pocket Holder for Slatwall 4"x9" (Clear) - \$20.00 ea			
SW-G 8" x 24" Slatwall Shelf w/Brackets (White) - \$44.00 ea			
SW-H 12" x 24" Slatwall Shelf w/Brackets (White) - \$56.00 ea			

Total \$ \_\_\_\_\_



Booth #: \_\_\_\_\_

QTY	DESCRIPTION	PRICE	TOTAL
	43" LED Monitor	\$520	
	Laptop Rental	\$195	
	Media Player Rental	\$65	
	iPad Rental*	\$150	

**\*Please note: Electrical is not included with your booth package.**

Subtotal	
TOTAL:	

\*Please note iPad Air is a Wifi only device, no cellular data is available.

**\*Please Note: For all Monitor Rentals, Electrical Set-up Labor will need to be ordered separately. Please refer to the appropriate page of the exhibitor manual for info on placing your electrical order.**

Please print or type contact information below:

<b>Contact Name:</b>
<b>Email:</b>
<b>Telephone:</b>
<b>Exhibiting Company:</b>
<b>Onsite Contact Name &amp; Phone #:</b>

# GRAPHIC SPECS & ART GUIDELINES

## GUIDE

- ▶ **Acceptable File Formats** - Editable PDF files (Hi Quality Print), EPS or Illustrator (Ai) files.
- ▶ **Color** - All files are printed in CMYK format. Please provide CMYK percentages.
- ▶ **Embed Graphics** - It is preferable to embed all art in the files. If you do not, please be sure to include all supporting art (fonts, linked images, vector art)
- ▶ **Font Specifications** - MUST be outlined. In Illustrator, select All (ctrl A) Go to Type > Create Outlines (or include fonts and linked images with uploaded print ready files).
- ▶ **Graphic Elements** - Keep type, and critical information (logos) at least 2 inches from all edges of the nished graphic.
- ▶ **No Bleeds or Crop Marks** - Create all graphics to specic dimensions. Please do not extend art over the artboards. We print directly to substrate and cut to exact dimensions (no white borders).
- ▶ **Resolution** - All raster files (hi-res photos) must be at 150-200 pixels per inch at 100%.
- ▶ **Specify** - Substrates, single or double-sided, quantities, grommets or pole pockets on banners.
- ▶ **Stand-Alones (36" x 84")** - Please keep all logos, type, and critical information at least 6 inches from bottom of the nished graphic to allow for base support.
- ▶ **Vector** - (outlined) art is always preferred because it will not pixelate if enlarged.
- ▶ **Do Not** - Please do not send artwork, logos, or graphics usingsMicrosoft or Corel.